

14  
15

18  
19  
20  
21  
22  
23  
24  
25  
26  
27  
28  
29  
30  
31  
32  
33  
34  
35  
36

Nov. 14. 1907

For cor. B.D.E.  
previsions, C

Established F.G.H. & A.X.

J. H. Hoolstencraft

"G" Concrete Stone: R. P. Tack in cor. post south 33°: R. P. Tack in fence post  
S.E. 46°

"H" Concrete Stone: R. P. Cor. of Concrete post SW 45°: R. P. Cor. of  
Concrete post N.W. 46°

"F" 6"  $\phi$  conc. std. @ on top cent. of intersection

"G" " " " " " cent. of road in line with N. of S fence

"H" " " " " " " "



SURVEY No. \_\_\_\_\_

Section 15 Town 105 Range 39

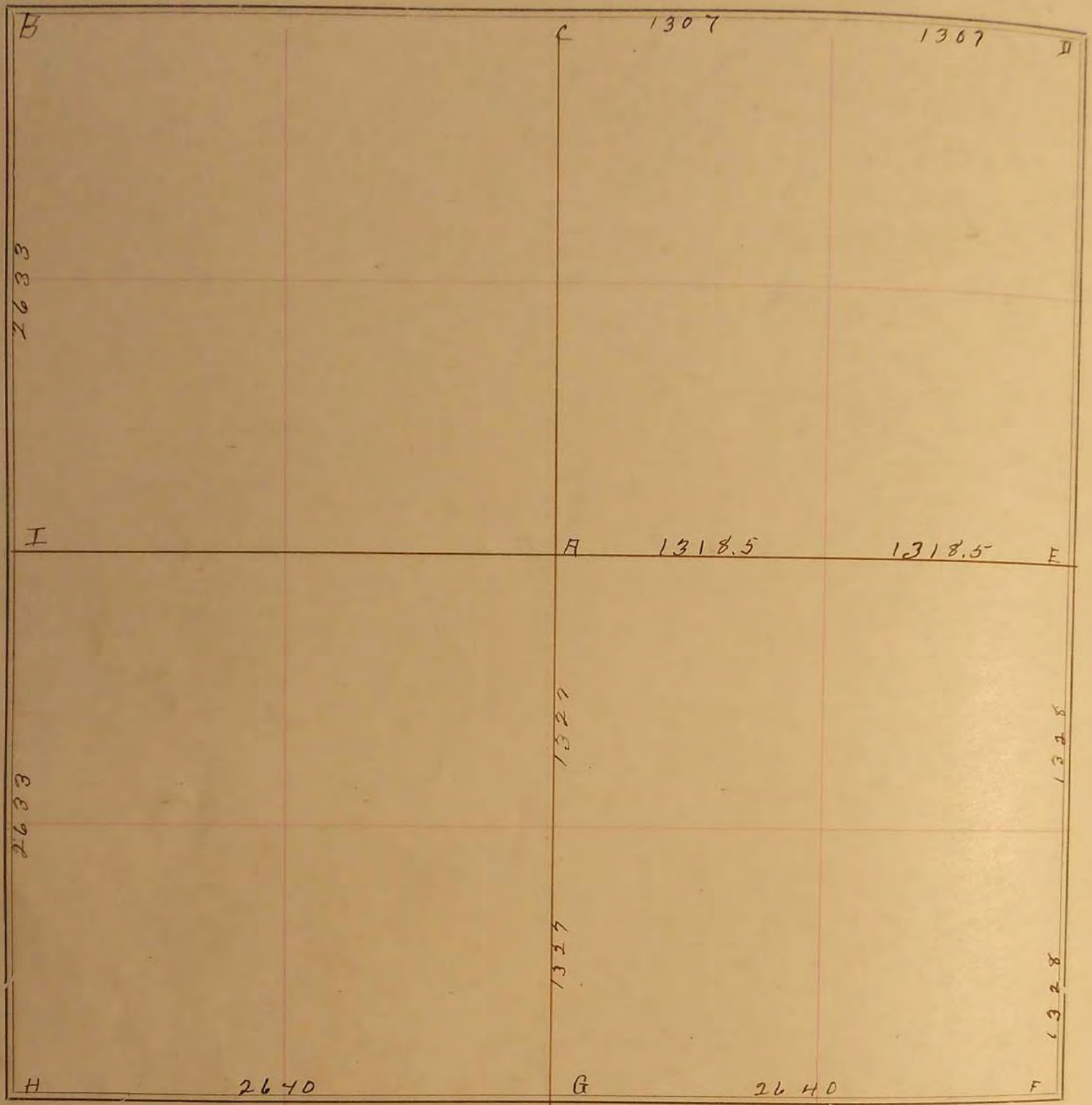

FIELD NOTES.

Nov. 14, 1907

Gov. Cor B D E

Previous C

Established F, G, H, I, A, X.

*J. W. Woodstein*

F 6" Round concrete Cyld. Marked Ⓞ on Top Center of Intersection

G " " " " " " " " Road in Line with N+S Fence

H " " " " " " " "